

PREFERRED REMEDIATION PLAN

Engineered Cap, Physical Containment and Removal of Some Materials

- Permeable Cap – covers 3.05 acres
- Impermeable Cap – covers 18.57 acres
- Steel Sheetpiling Containment Wall – 1,650 feet long
- Bulkhead Repair – 700 feet
- Limited Structure Remediation:
 - 125 tons of impacted material removed from the Site for disposal
 - 25,000 gallons of manufactured gas plant (MGP) residuals removed from the Site for disposal
 - 2,750 tons of trench soils
- Truck Traffic:
 - 140 trucks—transport and disposal
 - 4,900 trucks—clean material imported to the Site

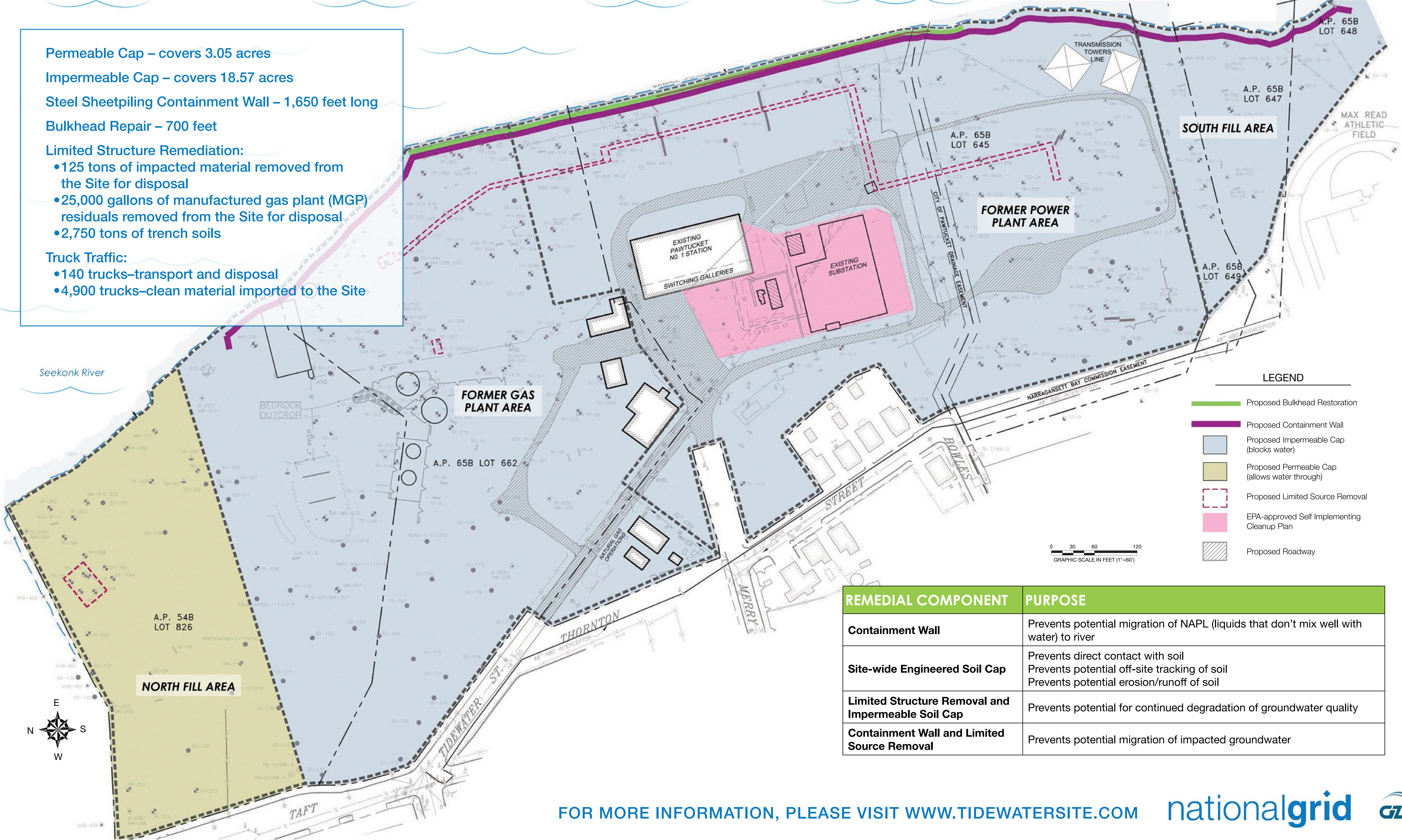

FOR MORE INFORMATION, PLEASE VISIT WWW.TIDEWATERSITE.COM